



Sean M. Gore
President & Chief Executive Officer

November 9, 2016

Mr. Tod Holweger
Department of Mineral Resources – Oil and Gas Division
600 E. Boulevard Ave. – Dept 405
Bismarck, North Dakota 58505-0840

Re: Status of Global Geophysical Services, Inc.

Dear Sir:

I am in receipt of your letters of October 18 and 21, 2016 requesting the Global Geophysical Services, Inc. ("Global") provide certain information to the Department of Mineral Resources of North Dakota related to Global's past activities in your state and provide an update on our current status.

Global entered bankruptcy in the United States on August 5, 2016 and reorganized itself under Chapter 11 of the Bankruptcy Code exiting bankruptcy as part of a pre-arranged plan with our senior lenders on October 3, 2016. As you may know, Global also went through a bankruptcy in 2014/2015 exiting that bankruptcy as a reorganized company on February 9, 2015.

As a foundational element of the Plan approved by the bankruptcy court, Global is in the process of liquidating its remaining assets and winding down its operations across the Globe. Currently, we have fewer than 10 employees in North America all focused on selling Global's remaining assets and executing on an orderly wind down. We no longer have the staff nor access to the information to provide the various reports and affidavits required under the laws of North Dakota regarding work performed up to 5 years ago in your state. I can appreciate that these items should have been filed by certain subcontractors of the Company or the Company itself during the time activities were ongoing and can only offer my apologies for these items not being completed and properly filed with the Department of Mineral Resources.

Should you have any further questions or concerns, please don't hesitate to contact me directly.

Regards,

A handwritten signature in black ink that reads "Sean M. Gore".

Sean M. Gore

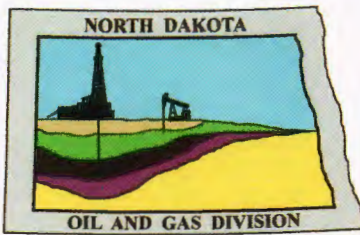

Oil and Gas Division

Lynn D. Helms - Director Bruce E. Hicks - Assistant Director

Department of Mineral Resources

Lynn D. Helms - Director

North Dakota Industrial Commission

www.dmr.nd.gov/oilgas/

October 18, 2016

Mr. Sean Gore
Chief Executive Officer
Global Geophysical Services, LLC
Corporate Headquarters
13927 South Gessner Road
Missouri City, TX 77489 US

RE: **Bankruptcy information**
 Geophysical Project paperwork

Dear Mr. Gore,

It is my understanding that Global Geophysical has filed for Chapter 11 bankruptcy protection. Therefore, at time we are requesting a letter indicating the US Bankruptcy Court status and a revised Organization report (Form GE2A). Also, we are requiring all paperwork noted below be filed as soon as possible. Alternatively, please submit a letter indicating why the information cannot be provided.

<u>PROJECT</u>	<u>PAPERWORK REQUIRED</u>
Sidonia 3-D	Completion report, Completion affidavit and Affidavit ND Century Code (NDCC) was sent to landowners.
Were 3-D	Affidavit NDCC was sent to landowners.
Mason Unit VSP	Affidavit NDCC was sent to landowners.
Macallan 3-D Phase I	Plugging affidavit.
Russian Creek 3-D	Plugging report and Plugging affidavit.
Round Prairie 3-D Phase II	Completion report, Completion affidavit & Affidavit NDCC was sent to landowners.
Round Prairie 3-D	Plugging report, Plugging affidavit, and Affidavit NDCC was sent to landowners.
Marmon Prospect 3-D	Affidavit NDCC was sent to landowners.

Should you have questions, feel free to call.

Sincerely,

Todd L. Holweger
Geophysical Supervisor

Enclosures:

- Forms: Organization report, Completion report, Completion affidavit, Plugging report, Plugging affidavit.
- Copy of Sidonia 3-D permit letter
- Pertinent chapters from the North Dakota Century Code (NDCC).

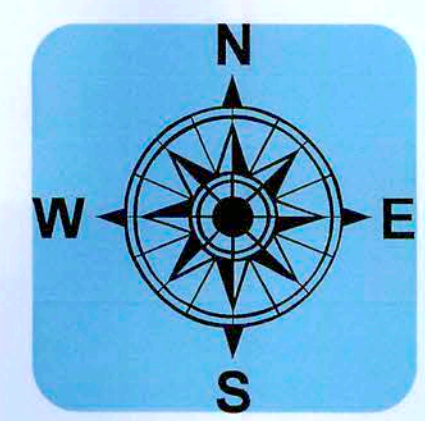

Round Prairie 3D

- Postplot_Sources
- Postplot_Receivers
- Barn
- || Bridge
- Cattle Guard
- Culvert
- Gas Well
- Gate Lock
- Gate Open
- Gate Vibe
- Pila
- Pivot
- Spring
- St
- St 600
- Tank
- Water Well
- Wm



GEOPHYSICAL EXPLORATION PERMIT

INDUSTRIAL COMMISSION OF NORTH DAKOTA
 OIL AND GAS DIVISION
 600 EAST BOULEVARD DEPT 405
 BISMARCK, ND 58505-0840
 SFN 51459 (02-2008)



1) a. Company Global Geophysical Services, Inc.	Address 13927 South Gessner Road, Missouri City, Texas 77489	
Contact Stephen Paine	Telephone 713-808-7255	Fax 713-808-7755
Surety Company Liberty Mutual	Bond Amount \$50,000.00	Bond Number 22022180
2) a. Subcontractor(s) Erickson Contract Surveying	Address 1101 5th St. SW, Sidney, MT 59270	Telephone 406-482-6606
b. Subcontractor(s) Allstate Permit Services	Address 708 1st St. N, New Town, ND 58763	Telephone 214-212-1524
c. Subcontractor(s)	Address	Telephone
3) Party Manager John Abbott	Address (local)	Telephone (local) 832-317-3347
4) Project Name or Line Numbers Round Prairie 3-D		
5) Exploration Method (Shot Hole, Non-Explosive, 2D, 3D, Other) Shot Hole, Non-Explosive (Vibroiseis) - 3-D		
6) Approximate Start Date January 20, 2010		Approximate Completion Date April 15, 2010

THE COMMISSION MUST BE NOTIFIED AT LEAST 24 HOURS IN ADVANCE OF COMMENCEMENT OF DRILL/PLUG OPERATIONS

7) Location of Proposed Project - County Williams County					
Section(s), Township(s) & Range(s)	Section Please see attached sheet	T.	R.		
	Section	T.	R.		
	Section	T.	R.		
	Section	T.	R.		
8) Size of Hole 3-D	Amt of Charge 5.5	Depth 40	Source points per sq. mi. 144	No. of sq. mi. 250	9) Must supply latitudes and longitudes of post-plot source and receiver points on an SD card.
Size of Hole 2-D	Amt of Charge	Depth	Source points per ln. mi.	No. of ln. mi.	

10) Anticipated special drilling and plugging procedures?
Pentolite loaded according to Rule 100; double capped

11) Enclose a pre-plot map with proposed location of seismic program lines and powder mag.

Signed <i>Stephen Paine</i>	Title Supervisor, US Permits & Logistics	Date January 15, 2010
(This space for State office use)		Conditions of Approval if any <i>See Attached letter</i>
Permit No. 970685	Approval Date 1/25/10	
Approved by <i>Tom W. Alvey</i>		
Title Mineral Resources Permit Manager		
County Approval Sent Williams		

Round Prairie 3D
Global Geophysical Services
Crew 444
1st Quarter 2010

	Township	Range	Sections:
Williams County ND	153 N	102 W	1,2,3,4,5,6,7,8,9,10,11,12,16,17 18,19,20,21,28,29,30,31,32,33
	154 N	102 W	1,2,3,4,5,6,7,8,9,10,11,12,13,14 15,16,17,18,19,20,21,22,23,24, 25,26,27,28,29,30,31,32,33,34,35,36
	155 N	102 W	19,20,21,22,23,24,25,26,27,28, 29,30,31,32,33,34,35,36
	153 N	103 W	1,2,3,4,5,6,7,8,9,10,11,12,13,14 15,16,17,18,19,20,21,22,23,24, 25,26,27,28,29,30,31,32,33,34,35,36
	154 N	103 W	1,2,3,4,5,6,7,8,9,10,11,12,13,14 15,16,17,18,19,20,21,22,23,24, 25,26,27,28,29,30,31,32,33,34,35,36
	155 N	103 W	5,6,7,8,17,18,19,20,21,22,23,24, 25,26,27,28,29,30,31,32,33,34,35,36
	153 N	104 W	1,2,3,10,11,12,13,14,15,22,23, 24,25,26,27
	154 N	104 W	1,2,3,10,11,12,13,14,15,22,23 24,25,26,27,34,35,36
	155 N	104 W	1,2,3,10,11,12,13,14,15,22,23 24,25,26,27,34,35,36

Round Prairie 3D

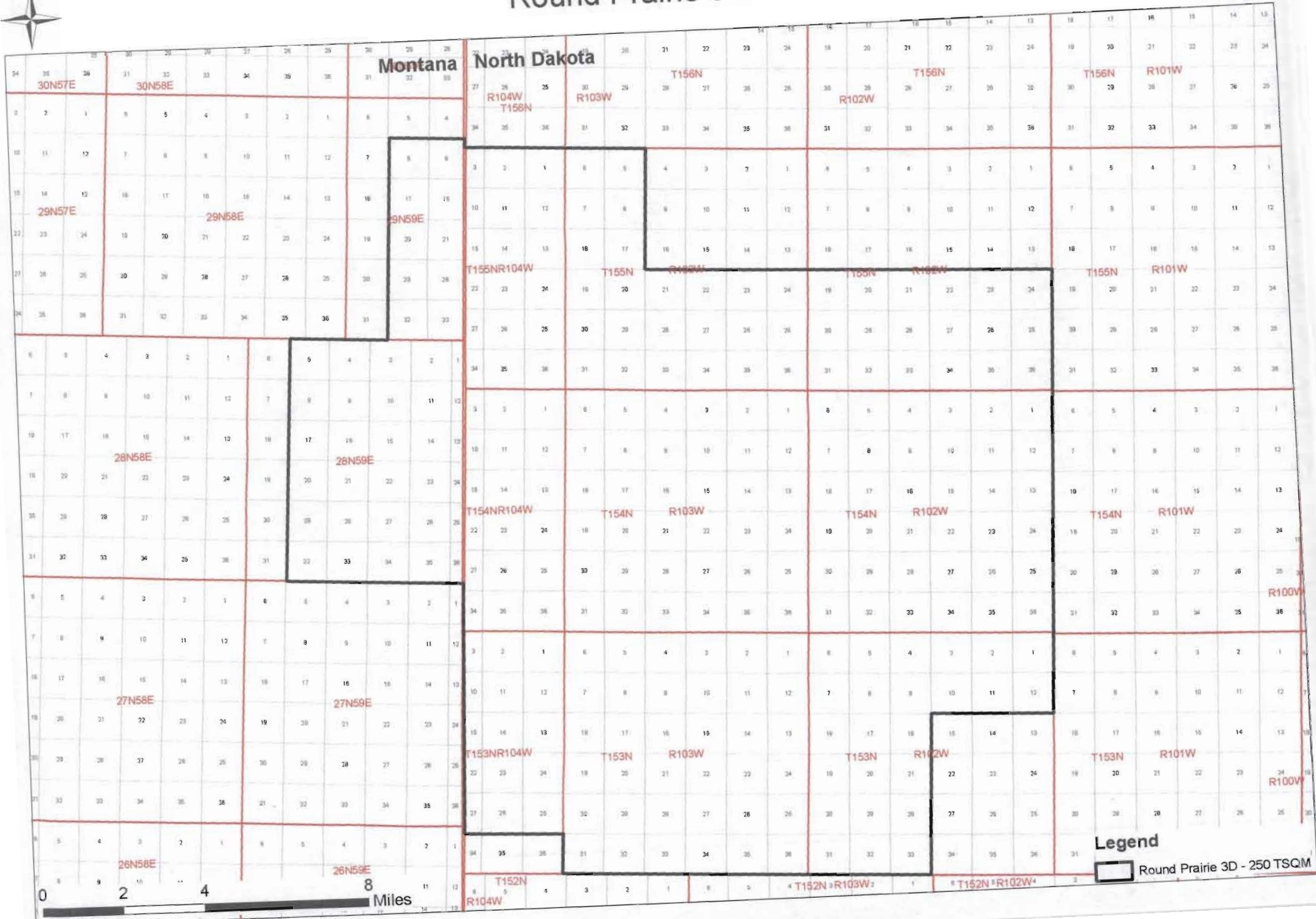

Montana

North Dakota

30N57E

30N58E

29N57E

29N58E

29N59E

28N58E

28N59E

27N58E

27N59E

26N58E

26N59E

T156N

T156N

T156N

R101W

R104W
T156N

R103W

R102W

T155NR104W

T155N

R103W

T155N

R102W

T155N

R101W

T154NR104W

T154N

R103W

T154N

R102W

T154N

R101W

T153NR104W

T153N

R103W

T153N

R102W

T153N

R101W

T152N
R104W

T152N * R103W

T152N * R102W

R100W

R100W

0 2 4 8 Miles

Oil and Gas Division

Lynn D. Helms - Director Bruce E. Hicks - Assistant Director

Department of Mineral Resources

Lynn D. Helms - Director

North Dakota Industrial Commission

www.oilgas.nd.gov

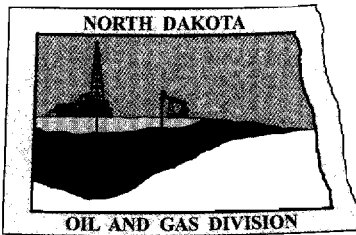

January 25, 2010

Mr. Stephen Paine
Supervisor,
Global Geophysical Services, Inc.
13927 S. Gessner Rd.
Missouri City, TX 77489

RE: Round Prairie 3-D
Geophysical Exploration Permit #97-0185
Williams County

Dear Mr. Paine:

Please be advised that we are in receipt of your Geophysical Exploration permit and it is conditionally approved; effective for one year from January 25, 2010. Review the following conditions for your permit:

1. A pre-program meeting with state seismic inspector Tom Torstenson may be required. You must contact him at 701-290-1546 (cell) or 701-227-7436 at least 24 hours prior to any exploration operations.
2. All variances for distance restrictions are to be furnished, and a pre-plot map displaying any source points that do not comply with the distance restriction rule must be supplied to the inspector.
3. The following information must be submitted within 30 days of the completion of the project by the Geophysical Company:
 - a. Completion Report,
 - b. Completion Affidavit,
 - c. Post Plot Map. It must show all water wells, buildings, underground cisterns, pipelines, and flowing springs that fall within the program area and within one half mile of the perimeter of the program.
 - d. SD card or email: ttorstenson@nd.gov with all source and receiver points,
 - e. Letter stating that the Geophysical Company has given all surface owner's a copy of the Section and Chapter of the NDCC as stated in paragraph 5.
4. The following information must be submitted within 30 days of the completion of the project by the SUBCONTRACTOR(s) (when applicable):
 - a. Plugging Report
 - b. Plugging Affidavit

5. It is required that within seven days of initial contact between the permitting agent and the operator of the land, the permitting agent shall provide the operator of the land and each landowner owning land within one-half mile of the land on which geophysical exploration activities are to be conducted a written copy of NDCC Section 38-08.1-04.1 (Exploration Permit) and NDCC Chapter 38-11.1 (Oil and Gas Production Damage Compensation). The permitting agent shall file an affidavit with this office confirming compliance with such notification. For your convenience, a copy of both Sections are enclosed.
6. The permit agent shall notify the operator of the land at least seven days before commencement of any geophysical exploration activity, unless waived by mutual agreement of both parties. The notice must include the approximate time schedule and the location of the planned activity.
7. Information for the locations of water wells, springs, etc.; refer to the following ND State Water Commission Mapservice website, at:
<http://mapservice.swc.state.nd.us/>
8. The entire permit can be viewed, as well as the status of various seismic projects in the state, at: <https://www.dmr.nd.gov/oilgas/seismic/seismicstats.asp>

Should you have any questions regarding this matter, feel free to contact me at 701-328-8020, or Tom Torstenson at the number listed in paragraph 1.

Sincerely,

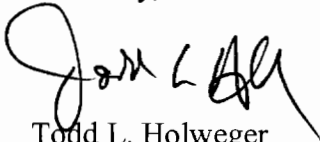

Todd L. Holweger
Mineral Resources Permit Manager

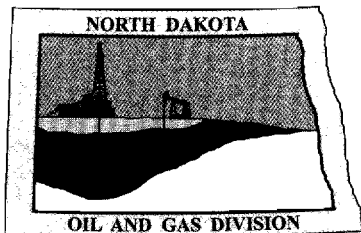

Oil and Gas Division

Lynn D. Helms - Director Bruce E. Hicks - Assistant Director

Department of Mineral Resources

Lynn D. Helms - Director

North Dakota Industrial Commission

www.oilgas.nd.gov

January 25, 2010

The Honorable Beth Innis
Williams County Auditor
P.O. Box 2047
Williston, ND 58802-2047

RE: Geophysical Exploration
 Permit #97-0185

Dear Ms. Innis:

Pursuant to Section 38-08.1-04.2 of the North Dakota Century Code, please be advised that Global Geophysical Services, Inc. was issued the above captioned permit on January 25, 2010 and will remain in effect for a period of one year. The entire permit can be viewed on our website at: <https://www.dmr.nd.gov/oilgas/seismic/seismicstats.asp>

Should you have any questions, please contact our office.

Sincerely,

A handwritten signature in black ink, appearing to read "Todd L. Holweger". The signature is stylized and somewhat cursive.

Todd L. Holweger
DMR Permit manager